



Resonator Gas Supply

5230 Series Regulator

The 5230 Series Regulators are intended for primary pressure control of laser gases supplied from cryogenic liquid cylinders or other low pressure sources where pressure fluctuations can be tolerated.

Advanced Features

- *Brass Barstock Body*
Smooth surface finish
- *Rear Panel Mountable*
Easy installation
- *Pressure Ranges 0-100 to 0-500 PSIG*
Broad range of applications
- *3,000 PSIG Inlet Pressure Rating*
Safe for use with high pressure cylinders
- *Capsule® Seat*
Increased serviceability and life
- *316L Stainless Steel Diaphragm*
No inboard diffusion
- *Low Wetted Surface Area*
Minimal purge requirements
- *Field Adjustable Pressure Limit*
Safeguard downstream equipment



Applications

Laser Gases from Pipeline

Nitrogen
Helium
Carbon Dioxide

Shielding Gases for Laser

Welding
Argon
Helium

Materials

Body

Brass barstock

Bonnet

Chrome-plated die cast zinc

Seat

PTFE

Filter

10-micron sintered bronze

Diaphragm

316L stainless steel

Internal Seals

PTFE

Specifications

Maximum Inlet Pressure

3,000 PSIG (210 BAR)

Temperature Range

-40 to 140°F (-40 to 60°C)

Gauge

2" diameter dual scale brass

Ports

1/4" FPT

Helium Leak Integrity

1 x 10⁻⁸ scc/sec

Cv

0.2

Weight

2.8 lbs. (2.16 kg)

Resonator Gas Supply

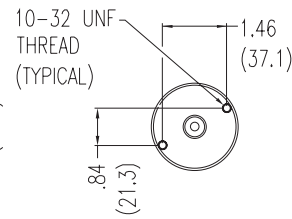
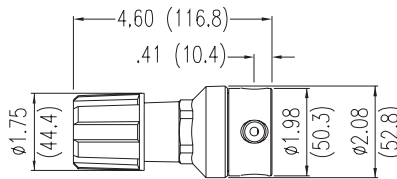
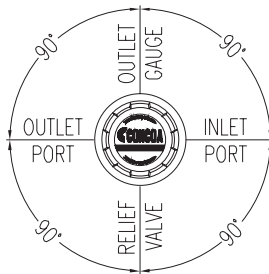
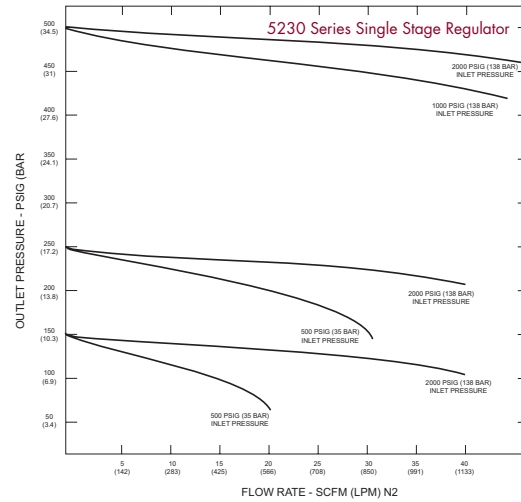
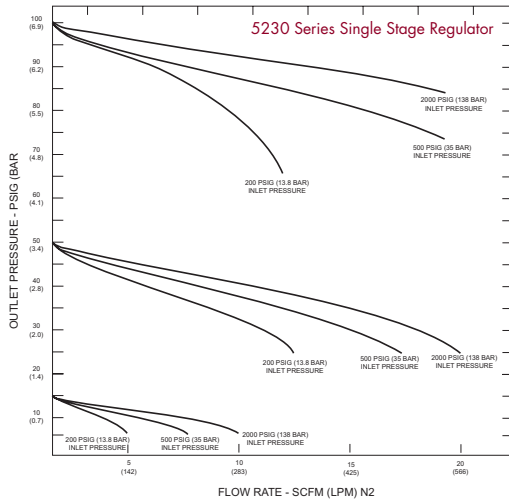

Ordering Information

5230	Part Number	Inlet	Delivery	Gas Service	Outlet
Series 5230	806-5230	1/4" Tube	0-500 PSIG (0-35 BAR)	Any Non-Corrosive Gas	1/4" Stainless Steel Compression Tube Fitting
	806-5232	1/4" Tube	0-250 PSIG (0-18 BAR)	Any Non-Corrosive Gas	
	806-5233	1/4" Tube	0-100 PSIG (0-7 BAR)	Any Non-Corrosive Gas	
	806-5237	1/4" Tube	0-60 SCFH - Argon 0-200 SCFH - Helium	Argon or Helium	1/8" Stainless Steel Compression Tube Fitting

Available Options

Options	Order Number	Description
Laser Gas Stations	See Page 8	Convenient regulator wall mount, including tee, bracket and flexible stainless steel pigtail with check valve in the inlet gland (Check valve not available on CGA 680 inlet models)
Laser Panels	See Page 9	Three Gas Panel delivery systems for the Laser Gases (Helium, Nitrogen and Carbon Dioxide)
Purge Devices	See Page 50	Tee and Straight Purge configurations to satisfy all requirements
Mounting Bracket	835-0204	Rear panel mount bracket kit.