



## 605 Series Manifold Regulator

The 605 Series Regulators are intended for pressure control at the source of either liquid or high pressure cylinders for applications with pressure requirements up to 250 PSIG.

### Advanced Features

- *Up to 3,000 PSIG Inlet Available*  
Liquid or high pressure use
- *High Flow Delivery Regulator*  
ISOFLOW™ seat design
- *40-Micron Internal Filter*  
Limits possibility of gas contamination
- *Balance Stem Seat*  
Eliminates decaying inlet pressure fluctuation
- *Stainless Steel Diaphragm*  
UHP design



605-3311-580 shown

### Applications

**Liquid or High Pressure**

**Cylinder Use**

Beam Purge  
N<sub>2</sub> or O<sub>2</sub> assist

**Bulk Gas Distribution Systems**

**Laser Welding Shielding Gases**

CO<sub>2</sub>, Argon, Helium

### Materials

**Body**

Brass barstock

**Bonnet**

Chrome-plated die cast zinc

**Seat**

PTFE

**Filter**

40-micron 316L stainless steel mesh

**Diaphragm**

316L stainless steel

**Internal Seals**

PTFE

### Specifications

**Maximum Inlet Pressure**

3,000 PSIG (210 BAR)

**Temperature Range**

-40°F to 140°F (-40°C to 60°C)

**Gauges**

2" diameter brass

**Ports**

½" FPT (inlet/outlet)  
¼" FPT (gauges)

**Helium Leak Integrity**

1 x 10<sup>-8</sup> scc/sec

**Cv**

1.0

**Weight**

4.4 lbs. (2 kg)

## Flow Performance Curves

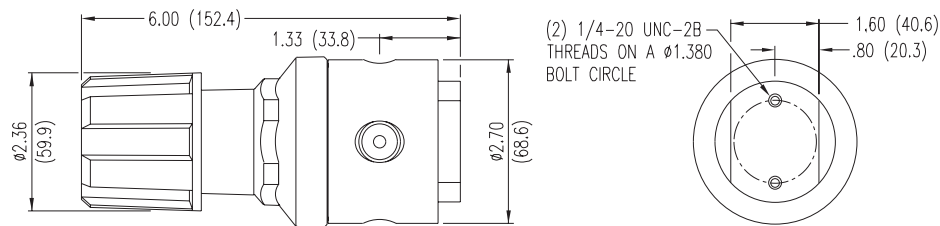
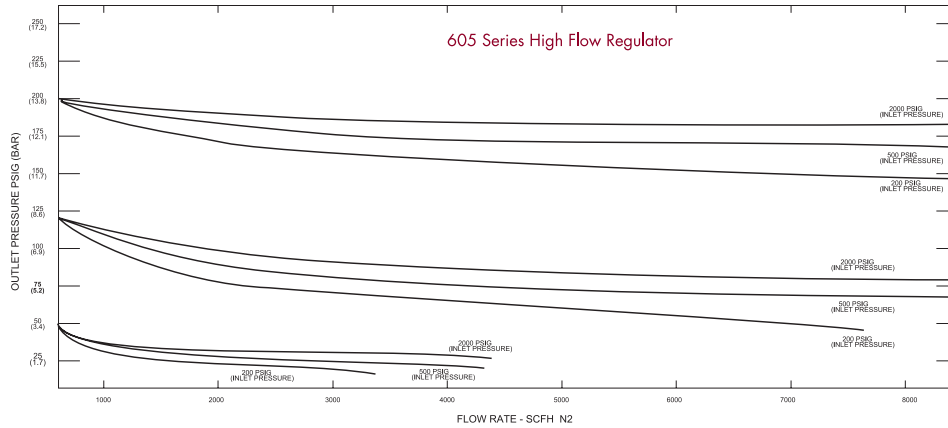

## Ordering Information

605	A	B	C	D	Inlet	Options	
Series 605	Outlet Pressure	Outlet Gauge	Inlet Gauge	Outlet Assemblies	Assembly/ Gauges	Connections	Installed Options
	1:0-15 PSIG	0-30 PSI	3:0-4000 PSI	0:1/2" FPT Port	1:Standard Assembly (PSI/kPa Gauges)	000:1/2" FPT	A:Laser Gas Alarm Station (110V)
	2:0-40 PSIG	0-60 PSI	9:0-600 PSI	1:1/2" Tube Fitting	2:Standard Assembly (BAR/PSI Gauges)	M12:12mm Tube Fitting	B:Laser Gas Alarm Station (220V)
	3:0-120 PSIG	0-200 PSI		2:12mm Tube Fitting		TF8:1/2" Tube Fitting	C:Laser Gas Switchover Station
	4:0-200 PSIG	0-400 PSI				CGA DIN 477	G:Laser Gas Switchover Station with Alarm (110V)
	5:0-250 PSIG	0-400 PSI				BS 341 and others available	H:Laser Gas Switchover Station with Alarm (210V)
							M:Laser Gas Station

## Related Options

Option	Order No.	Description
Laser Panels	See Page 9	Three Gas Panel delivery systems for the Laser Gases (Helium, Nitrogen and Carbon Dioxide)
Purge Devices	See Page 50	Tee and Straight Purge configurations to satisfy all requirements
Laser Gas Station	Add Letter "M" after inlet	Wall mount bracket, including stainless steel pigtail with check valve in the inlet gland
Mounting Bracket	835-0204	Rear panel mounting kit